



Digital Survey Plan - ML 352158

Survey Number ML 352158
Surveyor Reference Jacobsen 6552
Surveyor Graeme McNicol Haymes
Survey Firm Gilbert Haymes and Assoc Ltd
Surveyor Declaration I Graeme McNicol Haymes, being a person entitled to practise as a licensed cadastral surveyor, certify that -
(a) The surveys to which this dataset relates are accurate, and were undertaken by me or under my direction in accordance with the Cadastral Survey Act 2002 and the Surveyor-General's Rules for Cadastral Survey 2002/2;
(b) This dataset is accurate, and has been created in accordance with that Act and those Rules.
Declared on 28/04/2005.

Survey Details

Dataset Description Mangamaunu 2A12A & 2A12B Blocks
Purpose Partition
Status Approved as to Survey
Land District Marlborough
Coordinate System Marlborough 1949
Type Survey
Survey Class Class II Cadastral Survey

Survey Dates

Surveyed Date 06/04/2005
Submitted Date 28/04/2005 09:21:39
Deposit Date
Certified Date 28/04/2005
Survey Approval Date 17/05/2005

Referenced Surveys

Survey Number	Land District	Bearing Correction
LT 12063	Marlborough	0°00'00"
SO 2170	Marlborough	0°00'00"
SO 774	Marlborough	0°00'00"
SO 1579	Marlborough	0°00'00"
DP 3959	Marlborough	0°00'00"
SO 5551	Marlborough	0°00'00"
SO 3895	Marlborough	0°00'00"
DP 3237	Marlborough	0°00'00"

Territorial Authorities

Kaikoura District

Created Parcels

Parcels	Parcel Intent	Area	CT Reference
Mangamaunu 2A12A Block	Maori	0.1012 ha	
Mangamaunu 2A12B Block	Maori	4.1839 ha	
Total Area		4.2851 ha	



Mark and Observation

Survey Number ML 352158
Coordinate System Marlborough 1949

From	To	Code	Bearing	Adpt Surv	Distance	Adpt Surv
IS E SO 5551	IT I DP 12063	ob0	205°29'20"	M	62.83	M
IT I DP 12063	IS IV DP 3237	ob2	207°58'00"	M	120.68	M
IS IV DP 3237	IT VII SO 3895	ob9	292°22'00"	A DP 3237	10.48	A DP 3237
IS E SO 5551	IS I DP 3959	ob1	261°11'00"	A SO 5551	11.82	A SO 5551
IS I DP 3959	IT XXI SO 1579	ob11	47°57'40"	A DP 3959	9.44	A DP 3959
IT I DP 12063	PIN RA92 SO 5551	ob3	25°23'15"	M	78.25	M
IT I DP 12063	IT 1 ML 352158	ob4	37°53'00"	M	64.77	M
IT XXI SO 1579	PEG SO 2170	ob12	208°24'38"	A SO 2170	11.42	A SO 2170
IT I DP 12063	PEG 2 ML 352158	ob5	50°48'30"	M	80.81	M
IT I DP 12063	PEG 3 ML 352158	ob6	57°39'30"	M	21.80	M
IT I DP 12063	PEG 4 ML 352158	ob7	86°41'30"	M	36.17	M
IT I DP 12063	IT II DP 12063	ob8	312°23'00"	M	115.95	M
IT 1 ML 352158	PEG SO 2170	ob20	270°09'00"	A SO 2170	22.83	A SO 2170
IT VII SO 3895	PEG SO 774	ob10	120°48'00"	A SO 774	90.22	A SO 774
PEG SO 774	PEG SO 774	ob25	36°14'00"	A SO 774	10.11	A SO 774
PEG SO 774	PEG I SO 774	ob26	131°40'00"	A SO 774	105.09	A SO 774
PEG I SO 774	PEG XXVI SO 774	ob28	41°40'00"	A SO 774	181.05	A SO 774
PEG XXVI SO 774	PEG XXVII SO 774	ob29	343°10'00"	A SO 774	32.33	A SO 774
PEG XXVII SO 774	PEG SO 2170	ob30	343°10'00"	A SO 774	99.34	C
PEG SO 2170	PEG 2 ML 352158	ob31	270°09'00"	A SO 2170	115.34	C
PEG 2 ML 352158	IT 1 ML 352158	ob21	270°09'00"	A SO 2170	22.86	C
PEG SO 774	PEG SO774	ob27	300°48'00"	A SO 774	71.50	A SO 774
PEG SO774	PEG 3 ML 352158	ob32	28°24'38"	A SO 774	131.59	C
PEG 3 ML 352158	IT 1 ML 352158	ob23	28°24'38"	A SO 774	44.87	C
PEG 2 ML 352158	PEG 4 ML 352158	ob22	208°24'38"	C	55.69	C
PEG 4 ML 352158	PEG 3 ML 352158	ob24	298°24'38"	C	20.12	C
PIN RA92 SO 5551	IS E SO 5551	ob13	205°01'00"	M	15.42	M
PIN RA92 SO 5551	IT II DP 12063	ob14	273°35'10"	M	119.43	M
PIN RA92 SO 5551	IS IV DP 3237	ob15	206°56'50"	M	198.88	M
PIN RA92 SO 5551	IT 1 ML 352158	ob16	162°24'20"	M	20.54	M
PIN RA92 SO 5551	PEG 2 ML 352158	ob17	124°02'10"	M	35.08	M
PIN RA92 SO 5551	PEG 3 ML 352158	ob18	194°23'20"	M	60.94	M
PIN RA92 SO 5551	PEG 4 ML 352158	ob19	177°52'30"	M	68.65	M

Mark Name	Description
IS E SO 5551	0.35d
IT I DP 12063	fl.
PIN RA92 SO 5551	SS PIN SET IN CONCRETE IN SPUN CONCRETE PIPE.

*** End of Report ***

the drawing room
N.24B

OCCUPATION DIAGRAM

SURVEYOR'S PAGE

SURVEYOR

DATE

FB. No.

PLAN No. **352158**

PARTITION OF PT MANGAMAUNU SEC 12 OF 2A

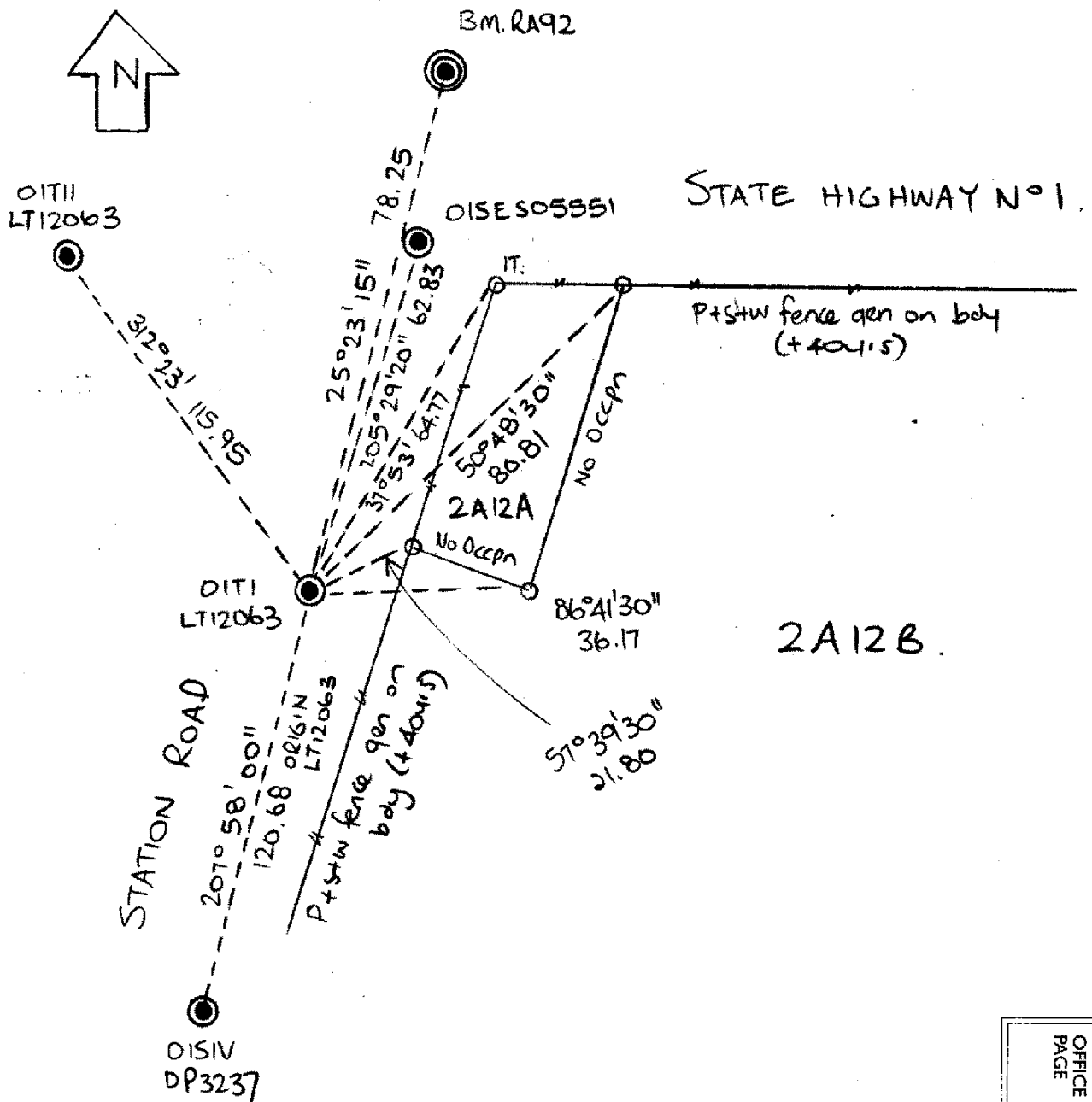

OFFICE
PAGE

