



Digital Title Plan - LT 384427

Survey Number LT 384427
Surveyor Reference 7388
Surveyor Denis McGregor Thomson
Survey Firm Thomson Survey Limited
Surveyor Declaration I Denis McGregor Thomson, being a person entitled to practise as a licensed cadastral surveyor, certify that -
(a) The surveys to which this dataset relates are accurate, and were undertaken by me or under my direction in accordance with the Cadastral Survey Act 2002 and the Surveyor-General's Rules for Cadastral Survey 2002/2;
(b) This dataset is accurate, and has been created in accordance with that Act and those Rules.
Declared on 11/10/2007.

Survey Details

Dataset Description Lot 1 Being formerly Allotment 1, Pt Allotments 2 & 3 of Section 1 Village of Taipa, Closed Road & Accretion Thereto
Status Approved as to Survey
Land District North Auckland
Submitted Date 11/10/2007
Survey Class Class I Cadastral Survey
Survey Approval Date 12/10/2007
Deposit Date

Territorial Authorities

Far North District

Comprised In

GN 1963 p1555
GN 1964 p140
GN 1959 p336

Created Parcels

Parcels	Parcel Intent	Area	CT Reference
Lot 1 Deposited Plan 384427	Hydro Fee Simple Title	0.2288 ha 1.7060 ha	337501
Total Area		<u>1.9348 ha</u>	

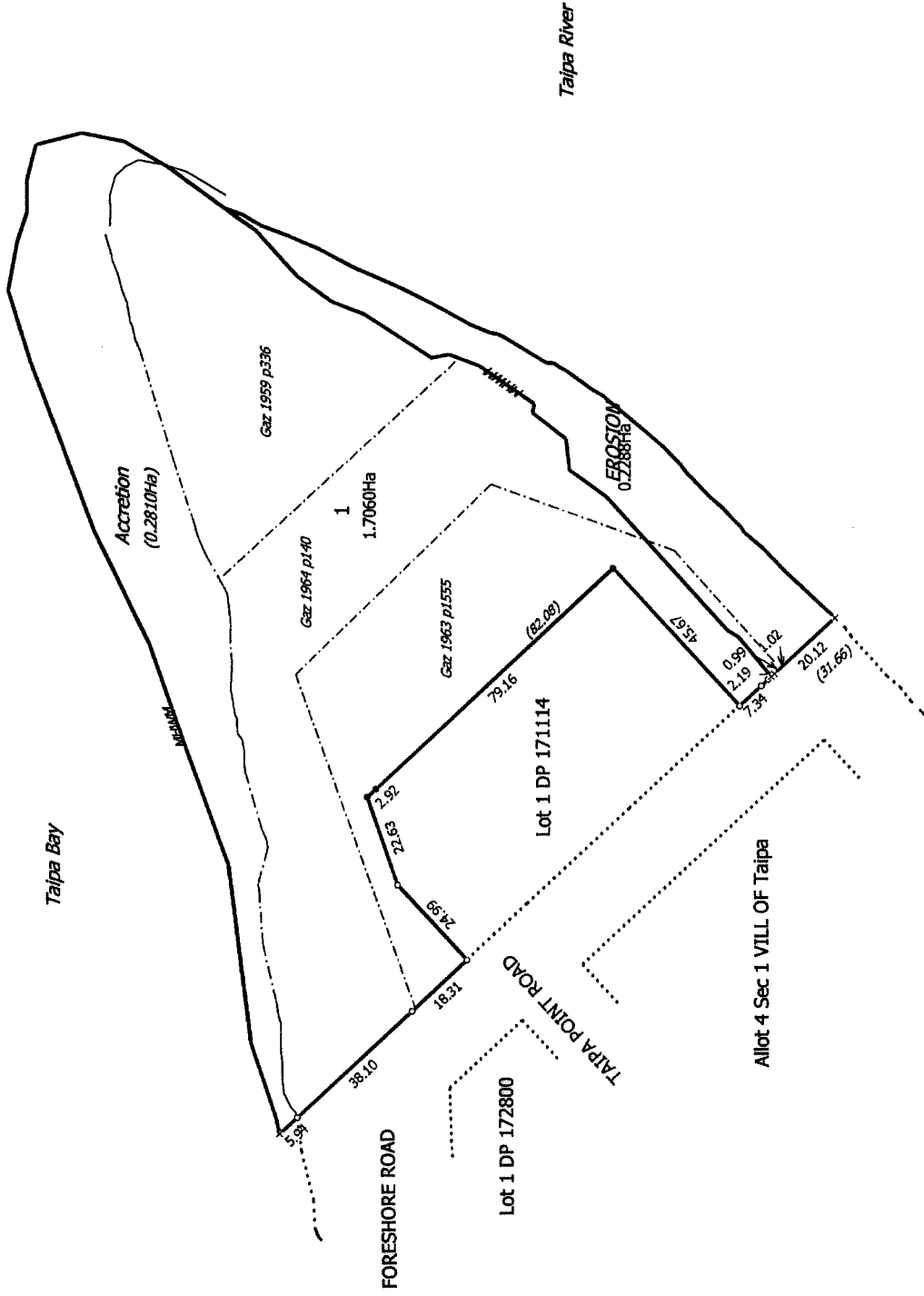

T 1/1

Surveyors Ref: 7388710C

Digital Title Plan
LT 384427
Approved on: 12/10/2007

Surveyor: Denis McGregor Thomson
Firm: Thomson Survey Limited

Lot 1 Being formerly Allotment 1, Pt Allotments 2 & 3 of Section 1 Village of Taipa, Closed Road & Accretion Thereto

Land District: North Auckland
Digitally Generated Plan
Generated on: 12/10/2007 08:43am Page 2 of 2